

# Licensing Act Sub-Committee



*St Edmundsbury*  
BOROUGH COUNCIL

<b>Title:</b>	<b>Agenda</b>
<b>Date:</b>	<b>Tuesday 4 August 2015</b>
	<b>2.00pm</b>
<b>Venue:</b>	<p><b>Room GFR14</b>  <b>West Suffolk House</b>          Western Way          Bury St Edmunds, IP33 3YU</p> <p>(Members will withdraw to the Mayor's Parlour to consider the application in private session)</p>
<b>Full Members (3):</b>	<p>Sarah Broughton          Beccy Hopfensperger          Sara Stamp</p>
<b>Substitute:</b>	Patsy Warby
<p><b>The membership of this Sub-Committee is drawn from Members of the full Licensing Committee and needs not to be politically balanced.</b></p>	
<b>Interests – Declaration and Restriction on Participation:</b>	<p>Members are reminded of their responsibility to declare any disclosable pecuniary interest not entered in the Authority's register or local non pecuniary interest which they have in any item of business on the agenda (subject to the exception for sensitive information) and to leave the meeting prior to discussion and voting on an item in which they have a disclosable pecuniary interest.</p>
<b>Quorum:</b>	Three Members
<b>Committee administrator:</b>	<p><b>David Long</b>          Committee Administrator &amp; SEBC Scrutiny Support  <b>Tel:</b> 01284 757120  <b>Email:</b> <a href="mailto:david.long@westsuffolk.gov.uk">david.long@westsuffolk.gov.uk</a></p>

# Agenda

Page No

## Procedural Matters

### Part 1 - Public

**1. Election of Chairman**

**2. Substitute**

The Member who is substituting for another Member should so indicate together with the name of the relevant absent Member.

**3. Apologies for Absence**

**4. The attached Hearing Procedure will be adopted in considering the undermentioned item:**

**1 - 2**

**5. Application for new Premises Licence - LPR Express, 99 Risbygate Street, Bury St Edmunds**

**3 - 38**

Report No. **LSC/SE/15/004**

### Part 2 - Private

NONE

## Licensing: Procedures at Hearings

1. The Chairman will introduce Members of the Committee and Officers present and ask all parties to identify themselves to the Hearing.
2. The Chairman will outline the procedure to be followed and:-
  - (a) check that all parties have received copies of relevant representations;
  - (b) ask all parties whether they wish to amend or withdraw their application or representation;
  - (c) ask the Licensing officer whether any party has submitted additional supporting information (only if all parties agree shall the material be distributed to the Sub-Committee);
  - (d) if the Licensing Officer reports any requests for a witness to appear, decide whether to allow the witness to speak and ask whether there are any further declarations of interest;
  - (e) agree how much time each person will need to present their case; and
  - (f) the Sub-Committee will determine whether the Substitute Member is required to hear the application.
3. The Licensing Officer will present the Statement of Facts.
4. The Chairman will invite Members and other parties to the hearing to ask questions of the Licensing Officer about the Statement of Facts.
5. The Chairman will invite the Applicant or representative to present their case and respond to questions from Members, Officers and other parties to the hearing.
6. The Chairman will invite those that have made objections or relevant representations to present their case and respond to questions from Members, Officers and all the other parties.
7. The Chairman will invite all parties to sum up their case and to confirm they are satisfied that they have said all they wish to say. (Nb the applicant should sum up last).
8. Members and Officers may ask any final questions and the Chairman will then give all parties an opportunity to respond on those points (Nb the last word should be from the Applicant).
9. The Sub-Committee, accompanied by the legal advisor and Committee Administrator will retire to determine the application.
10. The Chairman or legal advisor will announce the decision together with the reasons for it and will also outline rights of appeal.

### General Notes:

- (i) The hearing may be adjourned at any time at the discretion of the Members.
- (ii) Members may amend the procedure at any time if they consider it to be in the public interest or in the interest of a fair hearing.
- (iii) Members may exclude any person from the hearing if it appears to them to be in the public interest to do so or if that person is being disruptive.
- (iv) No parties will be allowed to cross examine unless Members agree that the procedure should be altered.
- (v) Any advice given in private session will be reported to all parties to the hearing.

This page is intentionally left blank

# Licensing Act Sub-Committee



*St Edmundsbury*  
BOROUGH COUNCIL

<b>Title of Report:</b>	<b>Application for New Premises Licence – LPR Express, 99 Risbygate Street, Bury St Edmunds</b>	
<b>Report No:</b>	<b>LSC/SE/15/004</b>	
<b>Decisions plan reference:</b>		
<b>Report to and date:</b>	<b>Licensing Act Sub-Committee</b>	4 August 2015
<b>Portfolio holder:</b>	Cllr Alaric Pugh Portfolio Holder for Planning and Growth <b>Tel:</b> 07930 460899 <b>Email:</b> alaric.pugh@stedsbc.gov.uk	
<b>Lead officer:</b>	Tom Wright Business Regulation and Licensing Manager <b>Tel:</b> 01638 719223 <b>Email:</b> tom.wright@westsuffolk.gov.uk	
<b>Purpose of report:</b>	To consider an application for a new premises' licence for LPR Express, 99 Risbygate Street, Bury St Edmunds  Three 'Other Persons' have submitted objections which have been accepted and the Sub-Committee are, therefore, required to determine the application.	

<b>Recommendation:</b>	<p><b>The Sub-Committee is requested to determine the application having regard to the four Licensing Objectives; Statement of Licensing Policy, the representations attached to this report, any further relevant information presented to the Sub-Committee on the day of the hearing, and having regard to the above, take any of the steps set out below provided they are proportionate and appropriate for the promotion of the four Licensing Objectives:</b></p> <p><b>The steps may be:</b></p> <p><b>(a) Grant the licence as applied for; or</b></p> <p><b>(b) Grant the licence, subject to such conditions as are consistent with the operating schedule accompanying the application, modified to such extent as the authority considers necessary for the promotion of the licensing objectives; or</b></p> <p><b>(c) Reject the whole or part of the application.</b></p>
<b>Key Decision:</b>	No, it is not a Key Decision - <input checked="" type="checkbox"/>
<b>Consultation:</b>	The applicant is required to place a notice on the premises; and advertise the application in a locally circulating newspaper/periodical. The Licensing Authority advertises the application on the Council website. The application met the statutory requirements.
<b>Alternative option(s):</b>	<ul style="list-style-type: none"> <li>N/A</li> </ul>
<b>Implications:</b>	
<i>Are there any <b>financial</b> implications? If yes, please give details</i>	Yes <input type="checkbox"/> No <input checked="" type="checkbox"/> •
<i>Are there any <b>staffing</b> implications? If yes, please give details</i>	Yes <input type="checkbox"/> No <input checked="" type="checkbox"/> •
<i>Are there any <b>ICT</b> implications? If yes, please give details</i>	Yes <input type="checkbox"/> No <input checked="" type="checkbox"/> •
<i>Are there any <b>legal and/or policy</b> implications? If yes, please give details</i>	Yes <input checked="" type="checkbox"/> No <input type="checkbox"/> • See No 2.1 below
<i>Are there any <b>equality</b> implications? If yes, please give details</i>	Yes <input type="checkbox"/> No <input checked="" type="checkbox"/> •
<b>Risk/opportunity assessment:</b>	<i>(potential hazards or opportunities affecting corporate, service or project objectives)</i>

Risk area	Inherent level of risk (before controls)	Controls	Residual risk (after controls)
Any decision reached which is not in accordance with the Act and any regulations made under the Act may be considered ultra vires and could be subject to an application for Judicial Review.	High	The Sub-Committee, in determining the application, should have regard to its statement of licensing policy and any guidance issued under section 182 of the Licensing Act 2003, but may depart from these where reasons are given.	Low
<b>Ward affected:</b>		Risbygate	
<b>Background papers:</b> <i>(all background papers are to be published on the website and a link included)</i>		Licensing Act 2003  S.182 Guidance <a href="http://www.gov.uk/government/publications/revised-guidance-issued-under-section-182-of-the-licensing-act-2003">www.gov.uk/government/publications/revised-guidance-issued-under-section-182-of-the-licensing-act-2003</a>  St Edmundsbury Borough Council Statement of Licensing Policy	
<b>Documents attached:</b>		<i>(Please list any appendices.)</i> Appendix 1 – Application Appendix 2 – Basic Location Plan Appendix 3 – Accepted Representations	

## **1. Key issues and reasons for recommendation(s)**

### **1.1 Key Issues**

1.1.1 An application has been received for a new premises licence for LPR Express, 99 Risbygate Street, Bury St Edmunds. A copy of the application is attached as **Appendix 1**.

1.1.2 The application seeks the supply of alcohol for consumption off the premises during opening hours.

Opening hours are Monday-Sunday 09.00 to 23.00

A basic location plan is attached as **Appendix 2**.

1.1.3 The four Licensing Objectives of the Licensing Act 2003 are set out below. Any representations for consideration must relate to one or more of these objectives.

- Prevention of Crime and Disorder
- Public Safety
- Prevention of Nuisance
- Protection of Children from Harm

### **1.1.4 Relevant Representations**

- (a) The application has to be advertised, both at the premises and in a local newspaper. Details are also available on the Council website.
- (b) Three accepted representations have been received and are attached as **Appendix 3**.

### **1.1.5 Matters for consideration**

- (a) Section 17 of the Crime and Disorder Act 1998 imposes a duty on each local authority to exercise its various functions with due regard to the likely effect of the exercise of those functions on, and the need to do all that it reasonably can to prevent crime and disorder in its area.
- (b) If the Licensing Authority decides that this application should be refused, it will need to show that to grant the licence would:
- undermine the promotion of the Licensing Objectives; and
  - that appropriate conditions would be ineffective in preventing the problems involved.

If the Licensing Authority cannot show the above, the application should be granted.

- (c) In making their decision, Members are advised to consider the Licensing Act 2003, the Guidance on the Act and the Council's



Statement of Licensing Policy.

1.1.6 **Other options considered**

No other relevant options were available.

**2. Additional supporting information**

2.1 **Legal and policy implications**

2.1.1 The Sub-Committee may take any of the steps set out below, provided they are proportionate and appropriate for the promotion of the licensing objectives:

- (a) Grant the licence as applied for; or
- (b) grant the licence, subject to such conditions as are consistent with the operating schedule accompanying the application, modified to such extent as the authority considers necessary for the promotion of the licencing objectives; or
- (c) reject the whole or part of the application.

A condition is modified where it is altered or omitted or any new condition is added.

2.1.2 Each application should be considered on its own merits, having regard to the Council's Statement of Licensing Policy and the guidance issued under Section 182 of the Licensing Act 2003.

2.1.5 The decision may be appealed, by the applicant or any other party to the hearing, within 21 days of written notification of the determination made by the Sub-Committee. The Sub-Committee should state in reaching its determination those matters which it considered relevant, those matters which it did not consider as they were irrelevant, and its reasons for the decision.

This page is intentionally left blank

[Insert name and address of relevant licensing authority and its reference number (optional).]

Application for a premises licence to be granted under the Licensing Act 2003

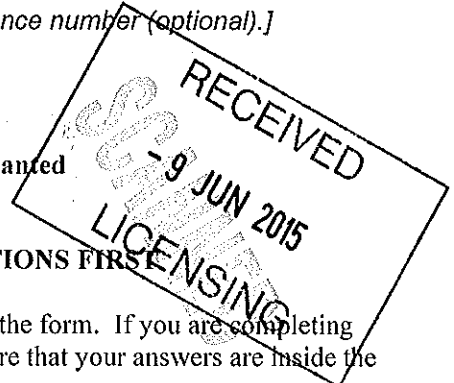

PLEASE READ THE FOLLOWING INSTRUCTIONS FIRST

Before completing this form please read the guidance notes at the end of the form. If you are completing this form by hand please write legibly in block capitals. In all cases ensure that your answers are inside the boxes and written in black ink. Use additional sheets if necessary.

You may wish to keep a copy of the completed form for your records.

I/we AMIN BAS FARAJDOON MAROUF  
 (Insert name(s) of applicant)

apply for a premises licence under section 17 of the Licensing Act 2003 for the premises described in Part 1 below (the premises) and I/we are making this application to you as the relevant licensing authority in accordance with section 12 of the Licensing Act 2003

Part 1 – Premises Details

Postal address of premises or, if none, Ordnance Survey map reference or description			
'LPR EXPRESS' 99 RISBYGATE STREET.			
Post town	BURY ST EDMUNDS	Postcode	IP33 3AA.

Telephone number at premises (if any)	
Non-domestic rateable value of premises	£ 10,500. (Band 1, 5)

Part 2 - Applicant Details

Please state whether you are applying for a premises licence as

Please tick as appropriate

- a) an individual or individuals \*  please complete section (A)
- b) a person other than an individual \*
  - i. as a limited company  please complete section (B)
  - ii. as a partnership  please complete section (B)
  - iii. as an unincorporated association or  please complete section (B)
  - iv. other (for example a statutory corporation)  please complete section (B)

- c) a recognised club  please complete section (B)
- d) a charity  please complete section (B)
- e) the proprietor of an educational establishment  please complete section (B)
- f) a health service body  please complete section (B)
- g) a person who is registered under Part 2 of the Care Standards Act 2000 (c14) in respect of an independent hospital in Wales  please complete section (B)
- ga) a person who is registered under Chapter 2 of Part 1 of the Health and Social Care Act 2008 (within the meaning of that Part) in an independent hospital in England  please complete section (B)
- h) the chief officer of police of a police force in England and Wales  please complete section (B)

\* If you are applying as a person described in (a) or (b) please confirm:

Please tick yes

- I am carrying on or proposing to carry on a business which involves the use of the premises for licensable activities; or
- I am making the application pursuant to a statutory function or
- a function discharged by virtue of Her Majesty's prerogative

**(A) INDIVIDUAL APPLICANTS** (fill in as applicable)

Mr <input checked="" type="checkbox"/>	Mrs <input type="checkbox"/>	Miss <input type="checkbox"/>	Ms <input type="checkbox"/>	Other Title (for example, Rev)	
Surname <b>MAROUF</b>			First names <b>FARADOON</b>		
I am 18 years old or over				<input checked="" type="checkbox"/> Please tick yes	
Current postal address if different from premises address		<b>99 RISBYGATE. STREET BURY ST EDMUNDS.</b>			
Post town		Postcode	<b>IP33 3AA.</b>		
Daytime contact telephone number					
E-mail address (optional)					

**SECOND INDIVIDUAL APPLICANT (if applicable)**

Mr <input type="checkbox"/>	Mrs <input type="checkbox"/>	Miss <input type="checkbox"/>	Ms <input type="checkbox"/>	Other Title (for example, Rev)	
Surname			First names		
I am 18 years old or over				<input type="checkbox"/>	Please tick yes
Current postal address if different from premises address					
Post town				Postcode	
Daytime contact telephone number					
E-mail address (optional)					

**(B) OTHER APPLICANTS**

**Please provide name and registered address of applicant in full. Where appropriate please give any registered number. In the case of a partnership or other joint venture (other than a body corporate), please give the name and address of each party concerned.**

Name
Address
Registered number (where applicable)
Description of applicant (for example, partnership, company, unincorporated association etc.)
Telephone number (if any)
E-mail address (optional)

**Part 3 Operating Schedule**

When do you want the premises licence to start?

DD	MM	YYYY
<input type="text"/>	<input type="text"/>	<input type="text"/>

If you wish the licence to be valid only for a limited period, when do you want it to end?

DD	MM	YYYY
<input type="text"/>	<input type="text"/>	<input type="text"/>

Please give a general description of the premises (please read guidance note 1)

CONVENIENCE / GROCERY STORE .

If 5,000 or more people are expected to attend the premises at any one time, please state the number expected to attend.

What licensable activities do you intend to carry on from the premises?

(Please see sections 1 and 14 of the Licensing Act 2003 and Schedules 1 and 2 to the Licensing Act 2003)

Provision of regulated entertainment

Please tick any that apply

- a) plays (if ticking yes, fill in box A)
- b) films (if ticking yes, fill in box B)
- c) indoor sporting events (if ticking yes, fill in box C)
- d) boxing or wrestling entertainment (if ticking yes, fill in box D)
- e) live music (if ticking yes, fill in box E)
- f) recorded music (if ticking yes, fill in box F)
- g) performances of dance (if ticking yes, fill in box G)
- h) anything of a similar description to that falling within (e), (f) or (g) (if ticking yes, fill in box H)

**Provision of late night refreshment** (if ticking yes, fill in box I)

**Supply of alcohol** (if ticking yes, fill in box J)

In all cases complete boxes K, L and M

**A**

Plays Standard days and timings (please read guidance note 6)			<b>Will the performance of a play take place indoors or outdoors or both – please tick</b> (please read guidance note 2)	Indoors	<input type="checkbox"/>
Day	Start	Finish		Outdoors	<input type="checkbox"/>
				Both	<input type="checkbox"/>
Mon			<b>Please give further details here</b> (please read guidance note 3)		
Tue					
Wed			<b>State any seasonal variations for performing plays</b> (please read guidance note 4)		
Thur					
Fri			<b>Non standard timings. Where you intend to use the premises for the performance of plays at different times to those listed in the column on the left, please list</b> (please read guidance note 5)		
Sat					
Sun					

**B**

<b>Films</b> Standard days and timings (please read guidance note 6)			<b>Will the exhibition of films take place indoors or outdoors or both – please tick</b> (please read guidance note 2)	Indoors	<input type="checkbox"/>			
				Outdoors	<input type="checkbox"/>			
				Both	<input type="checkbox"/>			
Day	Start	Finish	<b>Please give further details here</b> (please read guidance note 3)					
Mon								
Tue								
Wed						<b>State any seasonal variations for the exhibition of films</b> (please read guidance note 4)		
Thur								
Fri						<b>Non standard timings. Where you intend to use the premises for the exhibition of films at different times to those listed in the column on the left, please list</b> (please read guidance note 5)		
Sat								
Sun								



C

Indoor sporting events Standard days and timings (please read guidance note 6)			<u>Please give further details</u> (please read guidance note 3)
Day	Start	Finish	
Mon			
Tue			<u>State any seasonal variations for indoor sporting events</u> (please read guidance note 4)
Wed			
Thur			<u>Non standard timings. Where you intend to use the premises for indoor sporting events at different times to those listed in the column on the left, please list</u> (please read guidance note 5)
Fri			
Sat			
Sun			

**D**

<b>Boxing or wrestling entertainments</b> Standard days and timings (please read guidance note 6)			<b><u>Will the boxing or wrestling entertainment take place indoors or outdoors or both – please tick</u></b> (please read guidance note 2)	Indoors	<input type="checkbox"/>
				Outdoors	<input type="checkbox"/>
				Both	<input type="checkbox"/>
<b>Day</b>	<b>Start</b>	<b>Finish</b>	<b><u>Please give further details here</u></b> (please read guidance note 3)		
Mon					
Tue					
Wed					
Thur					
Fri					
Sat					
Sun					
			<b><u>State any seasonal variations for boxing or wrestling entertainment</u></b> (please read guidance note 4)		
			<b><u>Non standard timings. Where you intend to use the premises for boxing or wrestling entertainment at different times to those listed in the column on the left, please list</u></b> (please read guidance note 5)		

**E**

<b>Live music</b> Standard days and timings (please read guidance note 6)			<b>Will the performance of live music take place indoors or outdoors or both – please tick</b> (please read guidance note 2)	Indoors	<input type="checkbox"/>			
				Outdoors	<input type="checkbox"/>			
				Both	<input type="checkbox"/>			
Day	Start	Finish	<b>Please give further details here</b> (please read guidance note 3)					
Mon								
Tue								
Wed						<b>State any seasonal variations for the performance of live music</b> (please read guidance note 4)		
Thur								
Fri						<b>Non standard timings. Where you intend to use the premises for the performance of live music at different times to those listed in the column on the left, please list</b> (please read guidance note 5)		
Sat								
Sun								

**F**

<b>Recorded music</b> Standard days and timings (please read guidance note 6)			<b>Will the playing of recorded music take place indoors or outdoors or both – please tick</b> (please read guidance note 2)	Indoors	<input type="checkbox"/>			
				Outdoors	<input type="checkbox"/>			
				Both	<input type="checkbox"/>			
Day	Start	Finish	<b>Please give further details here</b> (please read guidance note 3)					
Mon								
Tue								
Wed						<b>State any seasonal variations for the playing of recorded music</b> (please read guidance note 4)		
Thur								
Fri						<b>Non standard timings. Where you intend to use the premises for the playing of recorded music at different times to those listed in the column on the left, please list</b> (please read guidance note 5)		
Sat								
Sun								

**G**

<b>Performances of dance</b> Standard days and timings (please read guidance note 6)			<b>Will the performance of dance take place indoors or outdoors or both – please tick</b> (please read guidance note 2)	Indoors	<input type="checkbox"/>
				Outdoors	<input type="checkbox"/>
				Both	<input type="checkbox"/>
Day	Start	Finish	<b>Please give further details here</b> (please read guidance note 3)		
Mon					
Tue			<b>State any seasonal variations for the performance of dance</b> (please read guidance note 4)		
Wed					
Thur			<b>Non standard timings. Where you intend to use the premises for the performance of dance at different times to those listed in the column on the left, please list</b> (please read guidance note 5)		
Fri					
Sat					
Sun					

# H

<b>Anything of a similar description to that falling within (e), (f) or (g)</b> Standard days and timings (please read guidance note 6)			Please give a description of the type of entertainment you will be providing		
Day	Start	Finish	<b>Will this entertainment take place indoors or outdoors or both – please tick</b> (please read guidance note 2)	Indoors	<input type="checkbox"/>
Mon				Outdoors	<input type="checkbox"/>
				Both	<input type="checkbox"/>
Tue			<b>Please give further details here</b> (please read guidance note 3)		
Wed					
Thur			<b>State any seasonal variations for entertainment of a similar description to that falling within (e), (f) or (g)</b> (please read guidance note 4)		
Fri					
Sat			<b>Non standard timings. Where you intend to use the premises for the entertainment of a similar description to that falling within (e), (f) or (g) at different times to those listed in the column on the left, please list</b> (please read guidance note 5)		
Sun					

**I**

<b>Late night refreshment</b> Standard days and timings (please read guidance note 6)			<b>Will the provision of late night refreshment take place indoors or outdoors or both – please tick</b> (please read guidance note 2)	Indoors	<input type="checkbox"/>
				Outdoors	<input type="checkbox"/>
				Both	<input type="checkbox"/>
<b>Day</b>	<b>Start</b>	<b>Finish</b>			
Mon			<u>Please give further details here</u> (please read guidance note 3)		
Tue					
Wed			<u>State any seasonal variations for the provision of late night refreshment</u> (please read guidance note 4)		
Thur					
Fri			<u>Non standard timings. Where you intend to use the premises for the provision of late night refreshment at different times, to those listed in the column on the left, please list</u> (please read guidance note 5)		
Sat					
Sun					

**J**

<b>Supply of alcohol</b> Standard days and timings (please read guidance note 6)			<b>Will the supply of alcohol be for consumption – please tick</b> (please read guidance note 7)	On the premises	<input type="checkbox"/>			
				Off the premises	<input checked="" type="checkbox"/>			
				Both	<input type="checkbox"/>			
Day	Start	Finish	<b>State any seasonal variations for the supply of alcohol</b> (please read guidance note 4)					
Mon	09 <sup>00</sup>	23 <sup>00</sup>						
Tue	09 <sup>00</sup>	23 <sup>00</sup>						
Wed	09 <sup>00</sup>	23 <sup>00</sup>						
Thur	09 <sup>00</sup>	23 <sup>00</sup>				<b>Non standard timings. Where you intend to use the premises for the supply of alcohol at different times to those listed in the column on the left, please list</b> (please read guidance note 5)		
Fri	09 <sup>00</sup>	23 <sup>00</sup>						
Sat	09 <sup>00</sup>	23 <sup>00</sup>						
Sun	09 <sup>00</sup>	23 <sup>00</sup>						

**State the name and details of the individual whom you wish to specify on the licence as designated premises supervisor:**

Name	MR. AMIN AZIZ BASHDAR.
Address	17 AXIOM. AVENUE. PETERBOROUGH. CAMBS
Postcode	PE3 7EH
Personal licence number (if known)	053669.
Issuing licensing authority (if known)	PETERBOROUGH CITY COUNCIL.



**M** Describe the steps you intend to take to promote the four licensing objectives:

a) General – all four licensing objectives (b, c, d and e) (please read guidance note 9)

WE WILL WORK CLOSELY WITH ALL RESPONSIBLE AUTHORITIES TO PROMOTE THE RESPONSIBLE SUPPLY OF ALCOHOL AT THE PREMISES. PREMISES WILL BE MONITORED BY CCTV. ALCOHOL PRODUCTS WILL BE LOCATED IN VIEW OF THE CASH TILL AREA

b) The prevention of crime and disorder

DIGITAL CCTV TO BE INSTALLED. RECORDINGS WILL BE HELD FOR AT LEAST 28 DAYS FOR INSPECTION BY RESPONSIBLE AUTHORITIES. INCIDENT BOOK TO BE MAINTAINED TO RECORD ALL REFUSALS AND INCIDENTS

c) Public safety

THE PREMISES WILL CONFORM TO HEALTH, SAFETY AND HYGIENE REGULATIONS

d) The prevention of public nuisance

PERSONS WHO APPEAR DRUNK WILL BE REFUSED THE SUPPLY OF ALCOHOL - LOGGED IN INCIDENT BOOK. ALCOHOL PURCHASES WILL BE CONSUMED AWAY FROM THE PREMISES

e) The protection of children from harm

'CHALLENGE 25' AGE VERIFICATION SCHEME WILL BE ADOPTED  
 REFUGAL LOG, OPERATED - TO BE INSPECTED BY RESPONSIBLE  
 AUTHORITIES UPON REASONABLE REQUEST.

**Checklist:**

Please tick to indicate agreement

- I have made or enclosed payment of the fee.
- I have enclosed the plan of the premises.
- I have sent copies of this application and the plan to responsible authorities and others where applicable.
- I have enclosed the consent form completed by the individual I wish to be designated premises supervisor, if applicable.
- I understand that I must now advertise my application.
- I understand that if I do not comply with the above requirements my application will be rejected.

**IT IS AN OFFENCE, LIABLE ON SUMMARY CONVICTION TO A FINE NOT EXCEEDING LEVEL 5 ON THE STANDARD SCALE, UNDER SECTION 158 OF THE LICENSING ACT 2003, TO MAKE A FALSE STATEMENT IN OR IN CONNECTION WITH THIS APPLICATION.**

**Part 4 – Signatures** (please read guidance note 10)

Signature of applicant or applicant's solicitor or other duly authorised agent (see guidance note 11).  
 If signing on behalf of the applicant, please state in what capacity.

Signature	
Date	05/06/15
Capacity	owner

For joint applications, signature of 2<sup>nd</sup> applicant or 2<sup>nd</sup> applicant's solicitor or other authorised agent (please read guidance note 12). If signing on behalf of the applicant, please state in what capacity.

Signature	
Date	
Capacity	

Contact name (where not previously given) and postal address for correspondence associated with this application (please read guidance note 13)

*PAUL BYATT*



LICENSED-INN-TUITION  
56 BROW OF THE HILL  
LEZIATE  
KING'S LYNN  
NORFOLK PE32 1EN

Post town

Postcode

Telephone number (if any)

If you would prefer us to correspond with you by e-mail your e-mail address (optional)

**Notes for Guidance**

1. Describe the premises, for example the type of premises, its general situation and layout and any other information which could be relevant to the licensing objectives. Where your application includes off-supplies of alcohol and you intend to provide a place for consumption of these off-supplies, you must include a description of where the place will be and its proximity to the premises.
2. Where taking place in a building or other structure please tick as appropriate (indoors may include a tent).
3. For example the type of activity to be authorised, if not already stated, and give relevant further details, for example (but not exclusively) whether or not music will be amplified or unamplified.
4. For example (but not exclusively), where the activity will occur on additional days during the summer months.
5. For example (but not exclusively), where you wish the activity to go on longer on a particular day e.g. Christmas Eve.
6. Please give timings in 24 hour clock (e.g. 16:00) and only give details for the days of the week when you intend the premises to be used for the activity.
7. If you wish people to be able to consume alcohol on the premises, please tick 'on the premises'. If you wish people to be able to purchase alcohol to consume away from the premises, please tick 'off the premises'. If you wish people to be able to do both, please tick 'both'.
8. Please give information about anything intended to occur at the premises or ancillary to the use of the premises which may give rise to concern in respect of children, regardless of whether you intend children to have access to the premises, for example (but not exclusively) nudity or semi-nudity, films for restricted age groups or the presence of gaming machines.
9. Please list here steps you will take to promote all four licensing objectives together.
10. The application form must be signed.
11. An applicant's agent (for example solicitor) may sign the form on their behalf provided that they have actual authority to do so.
12. Where there is more than one applicant, each of the applicant or their respective agent must sign the application form.
13. This is the address which we shall use to correspond with you about this application.

**Consent of individual to being specified as premises supervisor**

I AMIN AZIZ DASHDAR  
[full name of prospective premises supervisor]

of 17 AXIOM AVENUE  
PETERBOROUGH.  
CAMBS.  
PE3 7EH.

-----  
[home address of prospective premises supervisor]

hereby confirm that I give my consent to be specified as the designated premises supervisor in relation to the application for

PREMISES LICENCE.  
[type of application]

by

AMIN AZIZ DASHDAR  
[name of applicant]

relating to a premises licence \_\_\_\_\_  
[number of existing licence, if any]

for 'LPR EXPRESS'  
99 RUSBYGATE STREET  
BURY ST EDMUNDS  
IP33 3AA.

-----  
[name and address of premises to which the application relates]

and any premises licence to be granted or varied in respect of this application made by

Amin Aziz Bashdar.

[name of applicant]

concerning the supply of alcohol at

'LPR EXPRESS'

~~17 AXIOM AVENUE~~  
PETERBOROUGH  
P

99 ROSBYGATE STREET  
BURY ST EDMUNDS  
IP33, 3AA

[name and address of premises to which application relates]

I also confirm that I am applying for, intend to apply for or currently hold a personal licence, details of which I set out below.

Personal licence number

053669.

[insert personal licence number, if any]

Personal licence issuing authority

PETERBOROUGH CITY COUNCIL

[insert name and address and telephone number of personal licence issuing authority, if any]

Signed

Name (please print)

Amin BASHDAR

Date

05/06/15

LICENSING ACT 2003

*COPY*

**NOTICE OF APPLICATION FOR A PREMISES LICENCE**

Notice is given that Faraidoon Marouf has on the 10 June 2015, applied to St Edmundsbury Council as the Licensing Authority for the grant of a Premises Licence in respect of;

'LPR Express', 99 Risbygate Street, Bury St Edmunds, IP33 3AA.

To permit:

Sale of alcohol ( <i>for consumption off the premises</i> )	Mon – Sun	0900hr – 2300hrs
---	-----------	------------------

Anyone wishing to make representations concerning this application should do so in writing to: The Licensing Team, St Edmundsbury Council, West Suffolk House, Western Way, Bury St Edmunds, Suffolk, IP33 3YU.

Representations in respect of this application must reach the Licensing Authority by 07 July 2015 .

Persons wishing to inspect the register or the record of this application may do so by attending by appointment the office of the Licensing Section, during office hours, Monday to Friday inclusive.

It is an offence knowingly or recklessly to make a false statement in connection with an application, the maximum fine for which on summary conviction is £5,000.

LPR EXPRESS  
99 RIBBYGATE STREET.  
BURY ST EDMUNDS  
IP33 3AA.

SCALE. 1:100

8. JUNE 2015.

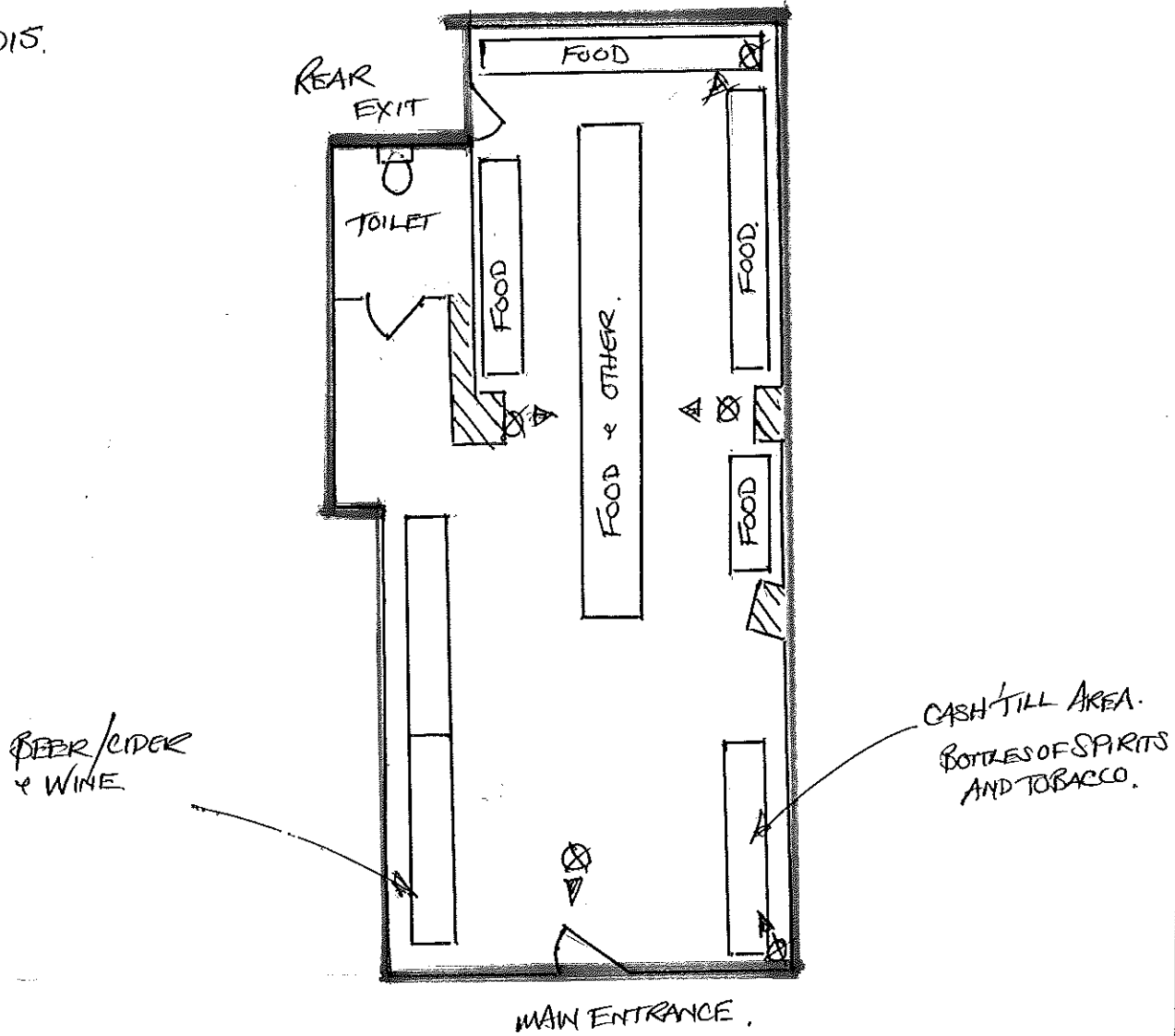

X CCTV CAMERAS

This page is intentionally left blank



# Basic Location Plan

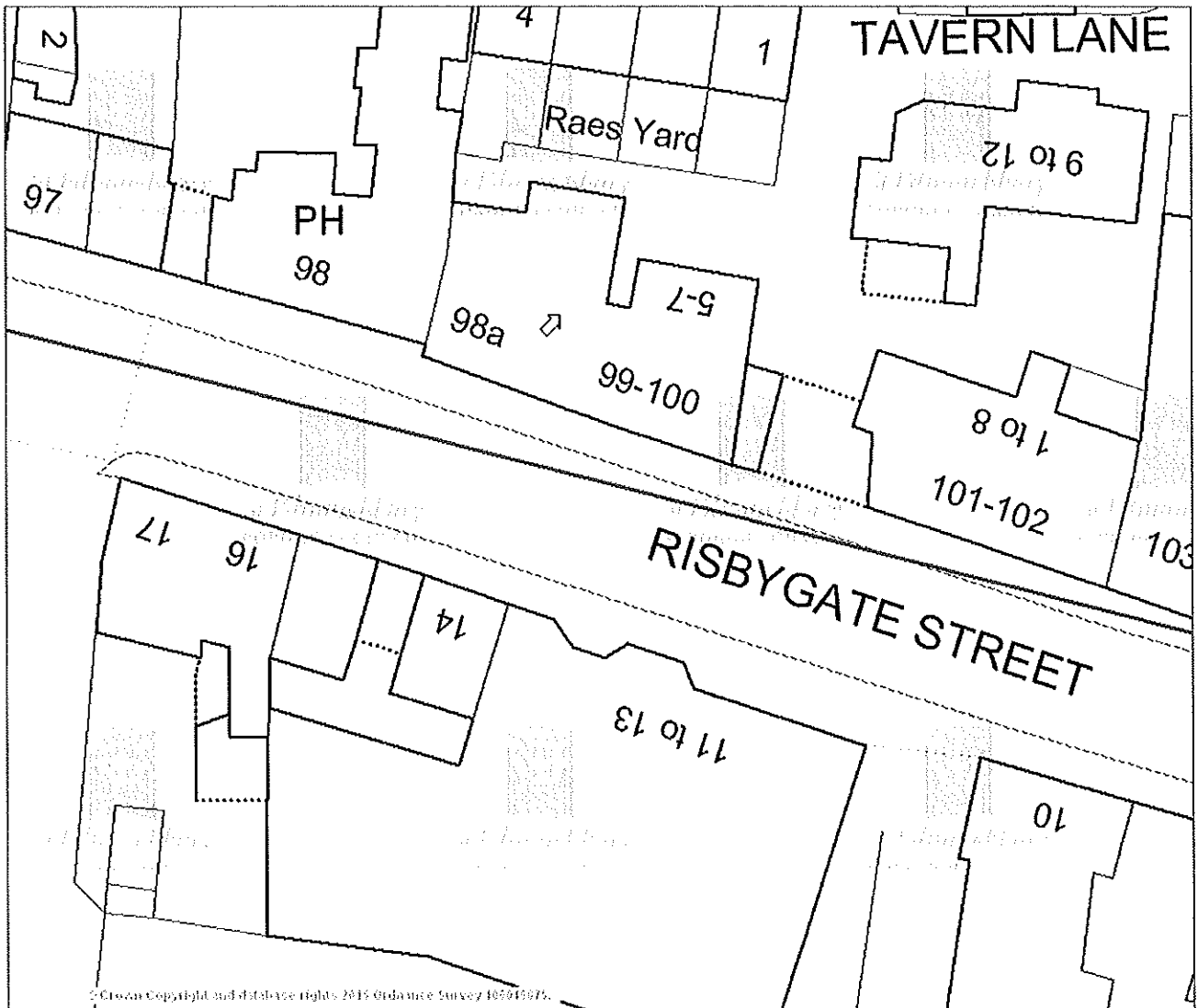

This page is intentionally left blank



**Thos Peatling Ltd**  
**98 Risbygate Street**  
**Bury St Edmunds**  
**IP33 3AA**  
**Tel: 01284 755948**  
**sales@thospeatling.co.uk**



16 June 2015

The Licensing Team  
St Edmundsbury Council  
West Suffolk House  
Western Way  
Bury St Edmunds  
IP33 3YU

Dear Sirs

RE: Licensing Act 2003 – To permit the sale of Alcohol - LPR Express, 99 Risbygate Street, Bury St Edmunds

I wish to express my concerns for permission being granted to the above premises for the sale of alcohol.

We are located to the rear of St Edmunds Tavern on Risbygate Street but are very aware of the large number of young adults from the college and bus station walking along Risbygate Street daily. A small number use our garden, without permission, for drinking. This is not only a public nuisance it leads to crime and disorder. We have reported several incidents of vandalism to the police. I feel that if alcohol was too readily available this problem would only get worse. I am also very concerned that the sale of alcohol 'til 11pm at night would only make matters a lot worse. I believe the increase in people potentially drinking on the street would be a public nuisance and lead to more vandalism.

The amount of empty cans which are littered about the street and our car park every day would only increase and as it is we pick up litter every morning. This would only get worse in my opinion. Please note that as a wine merchant we do not sell individual cans or bottles of alcohol so the 'said young adults' do not frequent our shop.

I look forward to hearing from you and trust you consider my concerns seriously.

Yours faithfully

Nicholas Corke  
Managing Director

5 Rae's Yard  
Bury St Edmunds  
Suffolk  
IP33 3EY

The Licencing Team  
St Edmundsbury Council  
West Suffolk House  
Western Way  
Bury St Edmunds  
Suffolk  
JP33 3YU



21/06/2015

Dear Sirs

**APPLICATION FOR A PREMISES LICENCE: 'LPR EXPRESS' - 99 RISBYGATE STREET, IP33 3AA**

I live directly above 99 Risbygate Street and I am writing to express my reservations to the application for a premises licence in order to sell alcohol.

A summary of my reservations can be noted below:

**PUBLIC ~~NUISANCE~~ NUISANCE**

- Late night – 11pm – customers leading to noise pollution and disturbances.
- Delivery early in the morning and late in the evening causing further disruption.

**CRIME AND DISORDER**

- Increased chance of alcohol being provided to already intoxicated individuals.
- Increased number of large groups in the nearby carpark and bus station.
- Increased littering in and around Tavern Lane and Risbygate Street.
- Increased potential crime rates due to type of goods available e.g. alcohol.

**PUBLIC SAFETY**

- Increased number of large groups in the nearby carpark and bus station.
- Unlikely to be security or CCTV cameras in operation, unlike at nearby clubs/Tesco.

**CHILD SAFETY**

- College and school children frequently walk through Risbygate Street on their way to/from school and college at Lunchtime and in the evenings/mornings.

- Increased risk of alcohol being sold to minors by untrained staff.

**OTHERS**

- One of Bid 4 Bury's main projects at present is to improve Risbygate Street and this doesn't appear to be in line with this.

Thank you for your time and I hope to have a reply from you shortly.

Yours faithfully

Antonia Corke

5 Rae's Yard  
Bury St Edmunds  
Suffolk  
IP33 3EY

The Licencing Team  
St Edmundsbury Council  
West Suffolk House  
Western Way  
Bury St Edmunds  
Suffolk  
IP33 3YU  
21/06/2015



Dear Sirs

**APPLICATION FOR A PREMISES LICENCE: 'LPR EXPRESS' - 99 RISBYGATE STREET, IP33 3AA**

As a resident living directly above the proposed new shop on Risbygate Street, I am writing to express my concern, reservation and opposition to the application for a premises licence in order to sell alcohol, referred to in the window of the aforementioned shop.

I live in a property immediately above 99 Risbygate Street and so I am directly affected by anything that happens in the three shops below the Rae's Yard flats. Indeed, the three flats and the three shops are managed by the same property management company – Temples - and our management fees are directly correlated to each other, based on floor space.

As such, I feel in the best position to be able to accurately express my opinion on this matter and the direct impact it will have on all the Rae's Yard residents and the residents on Risbygate Street and Tavern Lane too.

Areas where I fully expect there to be increased issues as a result of the issuing of this premises licence, in order to sell alcohol, would be:

**CRIME AND DISORDER**

With pubs and clubs within walking distance of this new proposed shop there is increased likelihood of alcohol being provided to already intoxicated individuals without the correct supervision occurring. This is already a hot topic in the press and presents an on-going issue in society.

With a public right of way right next to the shop and an open bus station and car park within 30 seconds of walking, there is already the issue of large groups of intoxicated and noisy individuals on Friday and Saturday evenings (and sometimes during the day too) and this is only going to further exacerbate this existing problem.

Furthermore, there is already a significant littering issue on Tavern Lane, Risbygate Street and Rae's Yard, with a lot of waste generated and thrown as people walk to and from the town centre on a daily basis. Offering people additional products to readily consume and then dispose of, will only increase the amount of litter which the residents of Rae's Yard and Tavern Lane will have to encounter. Evidence can be seen with a simple stroll down Tavern Lane.

With no obvious bins available, aside from those which belong to the residents, this problem cannot be easily resolved.

Finally, a business such as this, with items of stock which are inherently vulnerable to misappropriation – such as alcohol, chocolate bars, crisps, cigarettes etc. – is immediately likely to increase the risk of rising crime rate in the area.

#### **PUBLIC SAFETY**

As noted above, there are already issues relating to large groups of individuals found in both the open bus station and car park around this area and the extra availability of alcohol will only fuel this and make matters worse.

It is also noted that while there are similar products available at Tesco - just around the corner - at Tesco there is a security guard in place at all times on site, which acts as a safeguard to prevent alcohol being sold to large groups and already intoxicated individuals and large groups loitering outside the premises. It is unlikely this will be in place at the new shop on Risbygate Street.

In addition, there will be numerous CCTV cameras in operation at Tesco or the Co-Op which also act as a deterrent.

Furthermore, with bouncers in place at all of the nearby clubs, those who have been removed from these venues will look to shops like this for further sources of food and drink, where there is no such security in place. Meaning increased security issues for those in close proximity, i.e. the residents.

#### **PUBLIC NUISANCE**

It is noted within my leasehold agreement with Bury Town Trust, for a flat above the premises, that there is a clause relating to noise levels after 9pm. It clearly states that we are in breach of our lease if the noise levels are audible at street level after this time.

Given all the properties will be on leasehold agreements with Bury Town Trust and all will have been drawn up at a similar time with similar solicitors, one imagines there are similar clauses within them.

While on the licencing application it refers to the ability to sell alcohol to a time up to 11pm on 7 days of the week, which, to the best of my knowledge, would presumably lead to a direct contravention of the lease agreement given the likely noise levels of customers/staff at that time in the evening.

The noise levels alone would cause significant disruption to all residents on Risbygate Street and in particular those within close proximity on Rae's Yard and Tavern Lane. In particular at a time of the evening which is unsociable and not in-keeping with previous tenants in the shops in recent years.

In a business requiring regular stock replenishment, Risbygate Street does not lend itself to having regular deliveries. Parking is already a key issue and this is likely to cause further problems, or lead to deliveries at anti-social hours.

#### **CHILD SAFETY**

The public right of way on Tavern Lane is attached to the bus station, where everyday a significant number of children will walk by on their way to and from school. Given all of the issues noted above, having further bottles (broken or unbroken), cans (emptied or not) and other items which will have been discarded after purchase from this shop presents a real threat to these children on their way to or from school.

Furthermore, with the college only five-ten minutes away and on the walk from the college to the town centre this will only present an additional opportunity and temptation for them to attempt to buy alcohol at Lunch time or in the evenings.

In other stores located nearby, such as Tesco and Co-Op, there will be well trained and experienced staff who will have been appropriately trained to recognise and deal with underage customers. It is unlikely such extensive training will be available at a smaller, independent outfit, where there may be a significant shortfall in knowledge and experience if management are not operating the tills.

#### **AESTHETIC APPEAL OF RISBYGATE STREET**

Given the listed building status of these properties, including my own, the introduction of a shop of this nature is unlikely to do anything to improve the aesthetic appeal of these shops or the flats above them.

I would fully expect the value of the attached flats to diminish as a result of this application being accepted.

Thank you for the time taken to read my letter and I await your response. I should be grateful if you could please provide updates of the application process in due course, including results of the decision.

Kind regards

Yours faithfully

Thomas Coleman